

(1) (2)
SMR Federal
Code Stock
Number

(3)
DESCRIPTION

TM9-2320-211-34P

(4) (5) (6)
UNIT of meas
of inc. allowance
in

(7)
allowance

(8) (9) (10)
alw maint
per alw

100 per (a) (b)
equip100 Figure Item
cnt- equipNo. No.

Reference Number & Mfr. Code

Usable On Code

(a) (b) (c) (a) (b) (c)
1-20 21-5(51-10(1-20 21-5(51-10(gcy

1802-FENDERS,RUNNING BOARDS,
WINDSHIELDS

P-F	2590-473-63	BRACKET,DRUM: MS53052-1 (96906)	A	EA	1	*	*	*	*	*	*	3	5	133	1
P-F	2540-968-40	STRAP,WEBBING: 8690527 (19207)	A	EA	1	*	*	*	*	*	*	8	10	133	2
P-F	5320-950-45	RIVET,TUBULAR: WEBBING STRAP MS16535-235 (96906)	A	EA	8	*	*	*	*	*	*	6	10	133	3
P-F	5310-082-14	WASHER,FLAT: WEBBING STRAP MS15795-106 (96906)	A	EA	8	*	*	*	*	*	*	6	10	133	4
P-F	5305-269-28	SCREW,CAP,HEXAGON HEAD: BRACKET MS90726-58 (96906)	A	EA	8	*	*	*	*	*	*	6	10	133	5
P-F	2590-473-63	BRACKET,DRUM: MS53052-1 (96906)	A	EA	1	*	*	*	*	*	*	3	5	133	6
P-F	2540-960-40	STRAP,WEBBING: 8690527 (19207)	A	EA	1	*	*	*	*	*	*	8	10	133	7
P-F	5310-950-00	NUT,SELF-LOCKING,HEXAGON: MS21044N6 (96906)	A	EA	14	*	*	*	*	*	*	6	10	133	8
X2-F		DOOR: 10871479 (19207)	A	EA	1	*	*	*	*	*	*		133		9
P-F	2540-709-58	CATCH,RUNNING BOARD: 7539221 (19207)	A	EA	1	*	*	*	*	*	*	4	10	133	10
P-F	5310-959-76	NUT,SELF-LOCKING: ANGLE BRACKET MS51922-5 (96906)	A	EA	7	*	*	*	*	*	*	6	10	133	11
P-F	2510-741-10	BRACKET,ANGLE: LEFT RUNNING BOARD, FRONT AND REAR 7411085 (19207)	A	EA	2	*	*	*	*	*	*	3	5	133	12
P-F	5310-877-57	NUT,SELF-LOCKING,HEXAGON: ANGLE BRACKET MS21044N8 (96906)	A	EA	4	*	*	*	*	*	*	6	10	133	13
X2-F		BRACE: ANGLE BRACKET 10871475 (19207)	A	EA	2	*	*	*	*	*	*		133		14
P-F	5310-088-05	NUT,SELF-LOCKING,HEXAGON: MS21044N5 (96906)	A	EA	2	*	*	*	*	*	*	6	10	133	15
P-F	2540-408-46	SUPPORT,TOOL BOX: 10871476 (19207)	A	EA	2	*	*	*	*	*	*	2	5	133	16
P-F	5306-255-90	BOLT,MACHIN: TOOL BOX SUPPORT MS90726-31 (96906)	A	EA	2	*	*	*	*	*	*	6	10	133	17
P-F	5305-269-28	SCREW,CAP,HEXAGON HEAD: TOOL BOX BRACE MS90726-60 (96906)	A	EA	2	*	*	*	*	*	*	6	10	133	18
P-F	5305-269-28	SCREW,CAP,HEXAGON HEAD: TOOL BOX BRACKET MS90726-60 (96906)	A	EA	6	*	*	*	*	*	*	6	10	133	19
P-F	5306-225-90	BOLT,MACHINE: RUNNING BOARD MS90726-32 (96906)	A	EA	4	*	*	*	*	*	*	6	10	133	20

(1) (2)
SMR Federal
Code Stock
Number

(3)
DESCRIPTION

TM9-2320-211-34P

(4) (5) (6)
UNIT Qty of meas of inc. allowance
Unit

(7) (8) (9) (10)
Day Avail alw maint
allowance

(11) (12) (13) (14) (15) (16)
Illustration per alw
Figure Item
equip100 Figure Item
cnt-equipNo. No.

Reference Number & Mfr. Code

Usable On Code

(a) (b) (c) (a) (b) (c)
1-20 21-5(51-10(1-20 21-5(51-10(gcy

1802-FENDERS,RUNNING BOARDS,
WINDSHIELDS-CONTINUED

P-F	5310-809-40	WASHER, FLAT: MS27183-10 (96906)	A	EA	7	*	*	*	*	*	*	6	10	135	6
P-F	2540-709-58	CATCH, RUNNING BOARD: 7539221 (19207)	A	EA	1	*	*	*	*	*	*	3	5	135	7
P-F	2510-040-22	PANEL, HOOD: LEFT SIDE 8327038 (19207)	A	EA	1	*	*	*	*	*	*	3	5	135	8
P-F	5305-993-24	SCREW, MACHINE: PANEL ASSEMBLY MS35207-281 (96906)	A	EA	2	*	*	*	*	*	*	6	10	135	9
P-F	2510-177-77	PANEL ASSEMBLY, FENDER, RIGHT: 10871389 (19207)	A	EA	1	*	*	*	*	*	*	8	10	135	10
P-F	5310-809-59	WASHERE, FLAT: FENDER PANEL MS27183-17 (96906)	A	EA	4	*	*	*	*	*	*	6	10	135	11
P-F	2510-597-07	SPRING, HELICAL, COMPRESSION: FENDER (3) AND FENDER FRONT BOLT (3), 8327221 (19207)	A	EA	6	*	*	*	*	*	*	6	10	135	12
P-F	5310-809-40	WASHER, FLAT: MS15795-215 (96906)	A	EA	6	*	*	*	*	*	*	6	10	135	13
P-F	5310-950-00	NUT, SELF-LOCKING HEXAGON: MS21044N6 (96906)	A	EA	16	*	*	*	*	*	*	6	10	135	14
P-F	2510-753-91	ANTI-SQUEAK: FRONT FENDER TO CAB 7539199 (19207)	A	EA	1	*	*	*	*	*	*	4	8	135	15
P-F	5305-569-89	SCREW, CAP, HEXAGON HEAD: 125120R1 (31007)	A	EA	1	*	*	*	*	*	*	6	10	135	16
P-F	5305-269-28	SCREW, CAP, HEXAGON HEAD: 100033 (24617)	A	EA	2	*	*	*	*	*	*	6	10	135	17
P-F	5305-068-05	SCREW, CAP, HEXAGON HEAD: MS90726-5 (96906)	A	EA	1	*	*	*	*	*	*	6	10	135	18
P-F	5305-269-89	SCREW, CAP, HEXAGON HEAD: 8333064 (19207)	A	EA	3	*	*	*	*	*	*	6	10	135	19
P-F	5310-177-78	WASHER, FLAT: SUPPORT BRACKET 10871421 (19207)	A	EA	1	*	*	*	*	*	*	6	10	135	20
P-F	5310-740-95	WASHER, FLAT: SUPPORT BRACKET 7409564 (19207)	A	EA	1	*	*	*	*	*	*	6	10	135	21
P-F	2510-970-34	BRACKET, SUPPORT: 10899408 (19207)	A	EA	4	*	*	*	*	*	*	3	5	135	22
P-F	5340-597-23	SPRING, HELICAL COMPRESSION: SUPPORT BRACKET 8327223 (19207)	A	EA	4	*	*	*	*	*	*	6	10	135	23

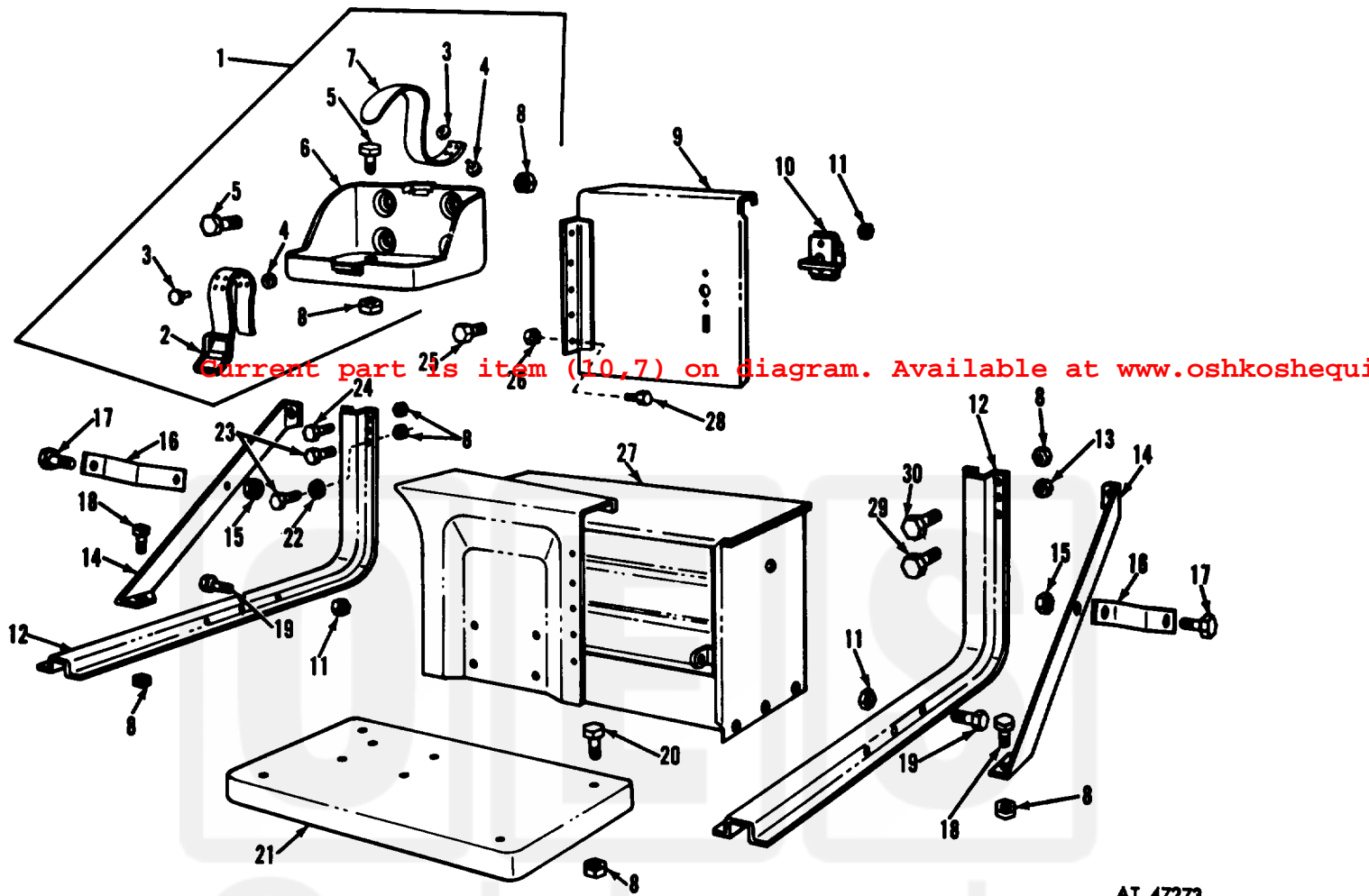

AT 47273

Figure 133. Left running board and related parts.

Oshkosh
Equipment Sales

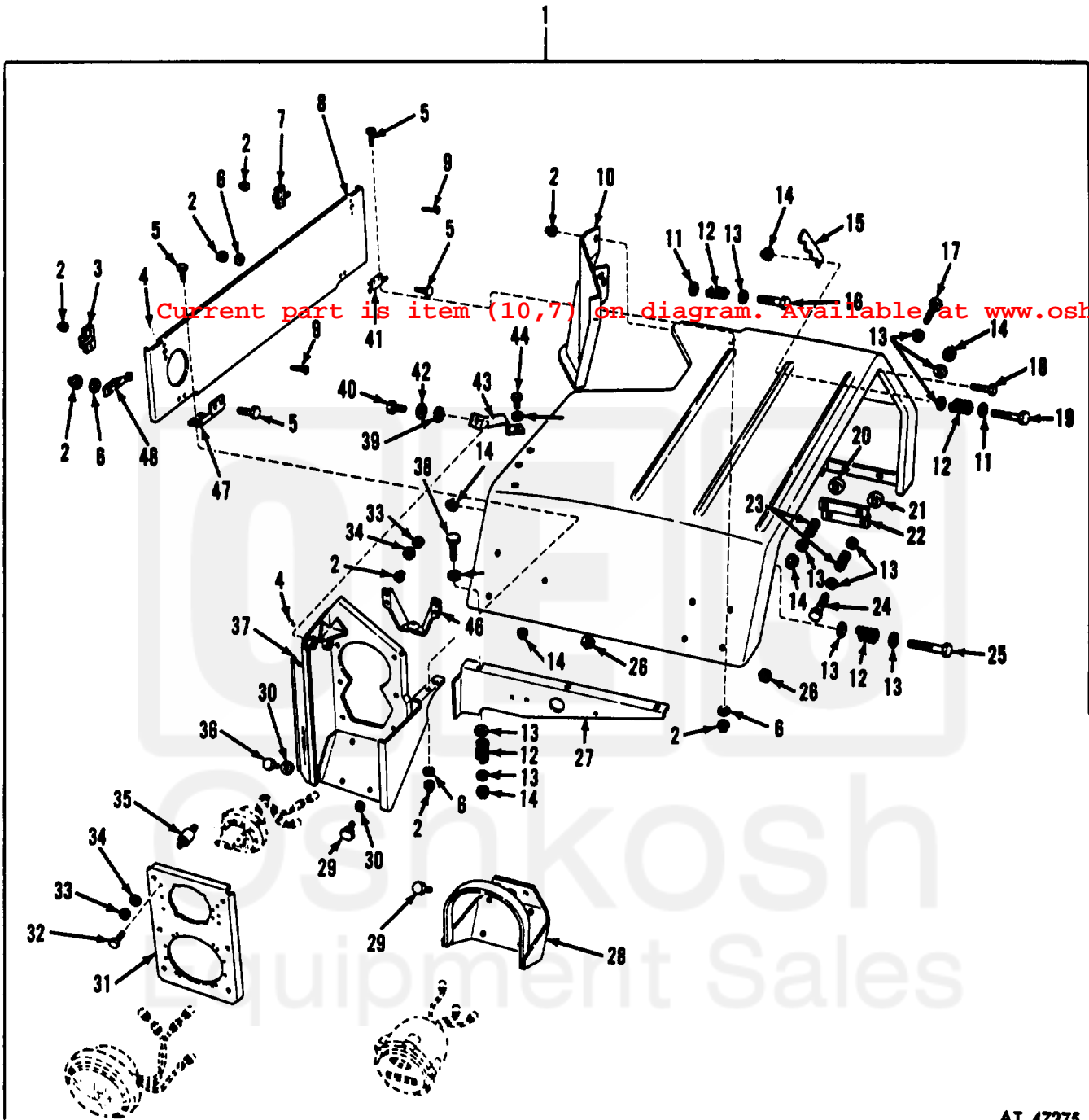

AT 47275

Figure 135. Left fender assembly and related parts.